

PRECISION INSTRUMENT COMPANY

SERIES '100' STEEL CASE UTILITY GAUGES

SPECIFICATIONS:

BLACK STEEL CASE WITH CHROME BEZEL
BRASS INTERNALS AND CONNECTION
DRY NON-FILLABLE
3-2-3 % ACCURACY

AVAILABLE DIAL SIZES:

1 1/2", 2", 2 1/2", 3 1/2", 4", 4 1/2"

AVAILABLE CONNECTION SIZES:

1/8"MNPT ON 1 1/2" AND 2"

1/4"MNPT ON 2" THRU 4"

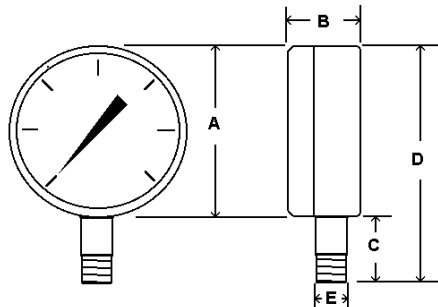

101D

	1 1/2"	2"	2 1/2"	3 1/2"	4 1/2"
A	1.64"/42mm	2.07"/53mm	2.50"/63mm	3.53"/90mm	4.89"/124mm
B	.93"/24mm	1.03"/26mm	1.17"/30mm	1.14"/29mm	1.16"/29mm
C	.63"/16mm	.83"/21mm	.86"/22mm	1.02"/26mm	1.16"/30mm
D	2.27"/58mm	2.90"/74mm	3.36"/85mm	4.55"/116mm	6.05"/154mm
E	1/8npt	1/8 or 1/4npt	1/4npt	1/4npt	1/4npt

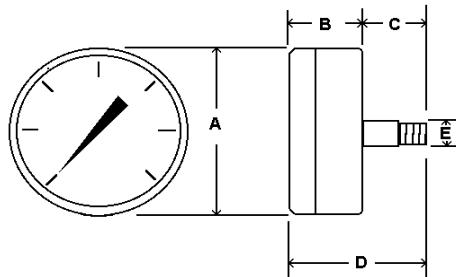

102D

	1"	1 1/2"	2"	2 1/2"
A	.99"/25mm	1.64"/42mm	2.07"/53mm	2.50"/63mm
B	.64"/16mm	.93"/24mm	1.03"/26mm	1.17"/30mm
C	.46"/12mm	.63"/16mm	.83"/21mm	.86"/22mm
D	1.10"/28mm	1.56"/39mm	1.86"/47mm	2.03"/52mm
E	1/8npt			

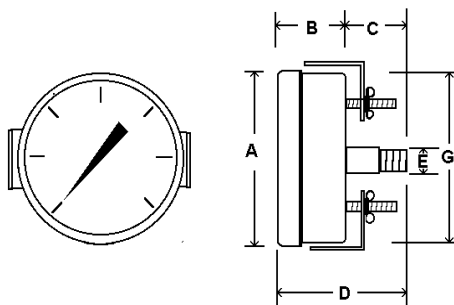

103D

	1 1/2"	2"	2 1/2"	3 1/2"
A	1.72"/44mm	2.26"/58mm	2.66"/68mm	3.97"/100.86mm
B	.98"/25mm	1.11"/28mm	1.28"/33mm	1.19"/30.16mm
C	.63"/16mm	.83"/21mm	.97"/24mm	.83"/21.20mm
D	1.61"/41mm	1.94"/49mm	2.25"/57mm	2.02"/51.36mm
E	1/8npt	1/8 or 1/4npt	1/4npt	1/4npt
F				
G	1.60"/41mm	2.04"/52mm	2.46"/63mm	3.59"/91.33mm

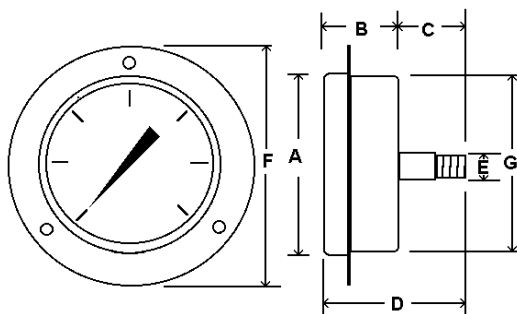

104D

	1 1/2"	2"	2 1/2"
A	1.72"/44mm	2.26"/58mm	2.66"/68mm
B	.98"/25mm	1.11"/28mm	1.28"/33mm
C	.63"/16mm	.83"/21mm	.97"/24mm
D	1.61"/41mm	1.94"/50mm	2.25"/57mm
E	1/8npt	1/8 or 1/4npt	1/4npt
F	2.47"/63mm	2.81"/71mm	3.44"/87mm
G	1.60"/41mm	2.04"/52mm	2.46"/63mm